

GOVERNMENT OF MAHARASHTRA

DETAILED ESTIMATE

Detailed Estimate for the Work of

Proposed Construction of Shed for Cattle Feed
Units, Storage of Raw Materials & Cattle Feed
for Atulniya Farmers Producer Company Ltd.
Waregaon Tq. Phulambri Dist. Aurangabad

Cost Rs. 51,53,756.00

JV Structural
Engineers & Consultants
Aurangabad

Name of Work :- Proposed Construction of Shed for Cattle Feed Units, Storage of Raw Materials & Cattle Feed for Atulniya Farmers Producer Company Ltd. Waregaon Tq. Phulambri Dist. Aurangabad

Index

Sr.No.	Particulars	Page From	Page To
1	Fund Head Sheet		
2	General Report		
3	Recapitulation Sheet		
4	Abstract		
5	Measurements		
12	Rate Analysis		
13	Lead Chart		
14	Quarry Chart		
15	Trial pit		
16	Working Drawing		

Name of Work :- Proposed Construction of Shed for Cattle Feed Units, Storage of Raw Materials & Cattle Feed for Atulniya Farmers Producer Company Ltd. Waregaon Tq. Phulambri Dist. Aurangabad

Fund Head Sheet

OFFICE :
SANCTIONED ESTIMATE NO.
FUND HEAD :
MAJOR HEAD
MINOR HEAD :
SERVICE HEAD :
DEPARTMENTAL HEAD :

Estimate framed for the probable expenses that will be incurred for the work of **Proposed Construction of Shed for Cattle Feed Units, Storage of Raw Materials & Cattle Feed for Atulniya Farmers Producer Company Ltd. Waregaon Tq. Phulambri Dist. Aurangabad**

Total Cost of work : 5153756.00

Administratively approved under No.

Estimate prepared by :

Estimate Checked by :

GENERAL REPORT

.....Attached Separately.....



JV Structural
Engineers & Consultants
Aurangabad

Name of Work :- Proposed Construction of Shed for Cattle Feed Units, Storage of Raw Materials & Cattle Feed for Atulniya Farmers Producer Company Ltd. Waregaon Tq. Phulambri Dist. Aurangabad

General Report

Following provisions are made in the estimate.

- 1) RCC framed structure with open foundation. **(Conc. Grade M-20)**
- 2) Providing **soling using 80 mm size Below Flooring ,Footing and loading platform**
- 3) Providing and laying **P.C.C. M-10 for Flooring & M15 for Footing**
- 4) Providing **Fly Ash 230mm thick** Brick Masonry for all External Walls.
- 5) Providing **internal cement plaster 12mm thick** in single coat without neeru finish & **External Sand faced plaster.**
- 6) Providing and laying in situ cement **concrete M20 with tremix treatment for 100 mm thickness** for flooring with groove cutting of 4mm wide and 20mm deep for godown floor
- 7) Providing and applying **washable oil-bound distemper in 2 coats for Internal Walls**
- 8) Providing and applying **three coats of Waterproof cement paint** for External Walls
- 9) Providing **Rolling Shutter** for Godown Entrance.
- 9) Providing and fixing in position powder coated aluminium louvered windows / ventilator
- 10) Providing and fixing of **colour coated Zinc aluminium Sheet** are Provided
- 11) Providing and fixing **22 B.W.G. plain galvanised iron sheets** Over Canopy

The rates are adopted as per State -E- SSR 2022-23 and nearest quarry is adopted for material.

So early technical sanction of the estimate is requested please.

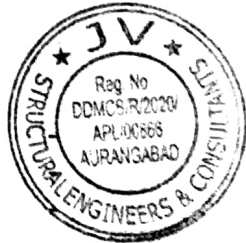



JV Structural
Engineers & Consultants
Aurangabad

Name of Work :- Proposed Construction of Shed for Cattle Feed Units,
Storage of Raw Materials & Cattle Feed for Atulniya Farmers Producer
Company Ltd. Waregaon Tq. Phulambri Dist. Aurangabad

Recapitulation Sheet

Sr. No.	Perticulars	Amount As per Estimate
1	Cost of Proper Building	42,01,265.00
2	Add 1% for Labour Insurance	42,013.00
3	Add 18% for G.S.T. Charges	7,56,228.00
4	Add For Electrification	1,54,250.00
Total Cost of Construction		51,53,756.00

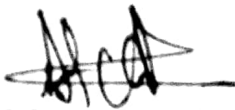

**JV Structural
Engineers & Consultants
Aurangabad**

Abstract

Name of Work :- Proposed Construction of Shed for Cattle Feed Units, Storage of Raw Materials & Cattle Feed for Atulniya Farmers Producer Company Ltd. Waregaon Tq. Phulambri Dist. Aurangabad

Abstract Sheet

Item No.	Item Of Work.	Qty.	Rate	Unit	Amount
Excavation					
1	Excavation for foundation in earth, soil of all types, sand, gravel and soft murum, including removing the excavated material up to a distance of 50 m. beyond the building area and stacking and spreading as directed, dewatering, preparing the bed for the foundation and necessary back filling, ramming, watering including shoring and strutting etc. complete. (Lift upto 1.5 m.) By Mechanical Means. Bd.A.1 Page 1 Number 259. SSR I.No. 21.02, Sr.No.721, P.No.153				
	Ground Floor	43.160	207.00	Cum	8934.00
2	Excavation for foundation in hard murum including removing the excavated material upto distance of 50 metres beyond the building area and stacking and spreading as directed, dewatering, preparing the bed for the foundation and necessary back filling, ramming, watering including shoring and strutting etc. complete. (Lift upto 1.50 m) By Mechanical Means Spec.No.: Bd.A.2 Page 1 Number 259 SSR I.No.21.06, Sr.No.725 P.No.153				
	Ground Floor	33.220	227.00	Cum	7541.00
3	Excavation for foundation in hard murum and boulders including removing the excavated material up to a distance 50 metres, beyond the building area and stacking and spreading as directed, dewatering, preparing the bed for the foundation and necessary back filling, ramming, watering including shoring and strutting etc. complete. (Lift upto 1.5m.) By Mechanical Means Spec. No. Bd.A.3 Page Number 259. SSR I.No. 21.10, Sr.No.728, P.No.154				
	Ground Floor	16.610	252.00	Cum	4186.00
4	Filling in plinth and floors with contractors material/brought from outside and approved by Engineer incharge in layers of 15 cm to 20 cm including watering and compaction etc. complete.. Spec. No. Bd.A.11 Page 1 Number 263. SSR I.No. 21.37, Sr.No. 751, P.No. 157				
	Ground Floor	130.090	818.98	Cum	106541.00
5	Providing soling using 80 mm size trap metal in 15 cm. layer including filling voids with Crushed sand/grit, ramming, watering etc. complete.. Spec. No. As directed by Engineer in charge. SSR I.No. 21.40, Sr.No. 754, P.No. 157				
	Ground Floor	49.870	2034.01	Cum	101436.00
Structural Steel Work					
6	Providing structural steel work in trusses, other similar trussed purlins and members with all bracing, gusset plates etc. as per detailed designs and drawings or as directed including cutting, fabricating, hoisting, erecting fixing in position, Making riveted/ bolted/ welded connection and one coat of anticorrosive paint and over it 2 coats of oil painting approved quality and shade etc. complete. Spec. No. Bd.C.2 Page Number 275 SSR I.No.23.04, Sr.No.819, P.No.173				
	Ground Floor	7.500	119459.00	M.T	895943.00

Abstract

Item No.	Item Of Work.	Qty.	Rate	Unit	Amount
Plain Cement Concrete					
7	Providing and laying Cast in situ/Ready Mix cement concrete in M-10 of trap/ granite/ quartzite/ gneiss metal for foundation and bedding including bailing out water, Steel centering, formwork, laying/pumping, compacting, roughening them if special finish is to be provided, finishing if required and curing complete, with fully automatic micro processor based PLC with SCADA enabled reversible Drum Type mixer/concrete Batch mix plant (Pan mixer) etc. complete. With fine aggregate (Crushed sand VSI Grade) Spec. No. Bd.E.1 Page 1 No. 287.SSR I.No.24.01, Sr.No.827, P.No.175				
	Ground Floor	33.250	5773.12	Cum	191956.00
8	Providing and laying Cast in situ/Ready Mix cement concrete in M15 of trap/ granite/quartzite/gneiss metal for bed blocks, foundation blocks and such other items including bailing out water, Steel centering, formwork, laying/ pumping, compacting, roughening them if special finish is to be provided, finishing uneven and honeycombed surface and curing etc. complete. The Cement Mortar 1:3 plaster is considered for rendering uneven and honeycombed surface only. Newly laid concrete shall be covered by gunny bag, plastic, tarpaulin etc. (Wooden centering will not be allowed.), with fully automatic micro processor based PLC with SCADA enabled reversible Drum Type mixer/ concrete Batch mix plant (Pan mixer) etc. complete. With fine aggregate (Crushed sand VSI Grade) Sepec. No. Bd.E.4 Page Number 289 and B7, Page Number38. SSR I.No. 24.08, Sr.No. 830, P.176				
	Ground Floor	8.300	6221.81	Cum	51641.00
9	Providing and laying in situ cement concrete M20 with tremix treatment for 100 mm thickness for flooring with groove cutting of 4mm wide and 20mm deep with necessary refilling with bitumen etc. complete. Sepec. No. As directed by Engineer in charge. SSR I.No. 33.30, Sr.No. 1017, P.216				
	Ground Floor	284.110	1283.40	Sqm	364627.00
10	Providing and laying in situ /Ready Mix cement concrete M-20 of trap / granite /quartzite/ gneiss metal for R.C.C. work in foundations like raft, strip foundations, grillage and footings of R.C.C. columns and steel stanchions etc. including bailing out water, Steel centering formwork, laying/pumping cover blocks, compaction and curing roughening the surface if special finish is to be provided (Excluding reinforcement and structural steel) etc. complete, with fully automatic micro processor based PLC with SCADA enabled reversible Drum Type mixer/ concrete Batch mix plant (Pan mixer) etc. complete. With fine aggregate (Crushed sand VSI Grade) Spec. No.Bd.F.3 Page 1 No. 298 and B.7, Page No.38. SSR I.No.25.11, Sr.No.836 P.No.178				
	Ground Floor	22.640	6881.00	Cum	155786.00
11	Providing and laying Cast in situ/Ready Mix cement concrete M-20 of trap / granite /quartzite/ gneiss metal for R.C.C. columns as per detailed designs and drawing or as directed including steel centering, formwork, cover blocks, laying/pumping, compaction finishing the formed surfaces with cement mortar 1:3 of sufficient minimum thickness to give a smooth and even surface or roughening if special finish is to be provided and curing etc. complete.(Excluding reinforcement and structural steel).with fully automatic micro processor based PLC with SCADA enabled reversible Drum Type mixer/ concrete Batch mix plant (Pan mixer) etc. complete. With fine aggregate (Crushed sand VSI Grade) Spec. No. : Bd.F.5 Page No. 300 and B.7, Page.No. 38.SSR I.No.25.31, Sr.No.841, P.No.179				
	Ground Floor	8.150	12892.10	Cum	105071.00

Abstract

Item No.	Item Of Work.	Qty.	Rate	Unit	Amount
12	Providing and laying Cast in situ/Ready Mix cement concrete M-20 of trap / granite /quartzite/ gneiss metal for R.C.C. beams and lintels as per detailed designs and drawings or as directed including steel centering, formwork, cover blocks, laying/pumping, compactionand roughening the surface if special finish is to be provided and curing etc. complete. (Excluding reinforcement and structural steel). with fully automatic micro processor based PLC with SCADA enabled reversible Drum Type mixer/ concrete Batch mix plant (Pan mixer) etc. complete. With fine aggregate (Crushed sand VSI Grade) Spec. No. :Bd.F.6 Page Number 300 and B.7, Page 1 Number38 Page.No. 38.SSR I.No.25.50, Sr.No.846, P.No.181				
	Ground Floor	7.440	11529.50	Cum	85779.00
13	Providing and fixing in position TMT - FE - 500 bar reinforcement of various diameters for R.C.C. pile caps, footings, foundations, slabs, beams columns, canopies, staircase, newels, chajjas, lintels pardis, copings, fins, arches etc. as per detailed designs, drawings and schedules. including cutting, bending, hooking the bars, binding with wires or tack welding and supporting as required complete.. Spec.No. Bd.F.17, Page 1 No. 306. SSR I.No.26.33, Sr.No.871, P.No.188				
	Ground Floor	3.490	89703.00	MT	313063.00
	Brick Work				
14	Providing fly ash brick masonry with conventional / I.S. type fly ash bricks in C.M. 1:6 in foundation and plinth including bailing out water manually striking joints, racking out joints watering and scaffolding etc. complete..Spec. No. As director by engineer in charge and BDG- 2 and 5. SSR I.No.27.12, Sr.No.899 P.No.198				
	Ground Floor	12.800	7542.97	Cum	96550.00
15	Providing fly ash brick masonry with conventional/ I.S. type bricks in cement mortar 1:6 in superstructure including striking joints, raking out joints, watering and scaffolding etc. Complete. Spec. No. As director by engineer incharge and BDG- 2 and 5. SSR I.No.27.13, Sr.No.900 P.No.198				
	Ground Floor	14.050	7764.97	Cum	109098.00
	Plastering & Pointing				
16	Providing internal cement plaster 12mm thick in single coat in cement mortar 1:5 without neeru finish to concrete or brick surfaces, in all positions including scaffolding and curing etc. complete Spec. No. : Bd.L.4 Page 1 No. 368. SSR I.No.32.03, Sr.No.957, P.No.209				
	Ground Floor	74.600	274.95	Sqm	20511.00
17	Providing sand faced plaster externally in cement mortar using approved screened sand, in all positions including base coat of 15 mm thick in cement mortar 1:4 using waterproofing compound at 1Kilogramper cement bag curing the same for not less than 2 days and keeping the surface of the base coat rough to receive the sand faced treatment 6 to 8 mm thick in cement mortar 1:4 finishing the surface by taking out grains and curing for fourteen days scaffolding etc.complete. Spec. No. : Bd.L.7 Page 1 No. 369. SSR I.No.32.11, Sr.No.963, P.No.209				
	Ground Floor	133.200	647.69	Sqm	86272.00

Abstract

Item No.	Item Of Work.	Qty.	Rate	Unit	Amount
Paving, Flooring & Dado					
18	Providing and laying machine cut machine Polished Kota stone flooring 25mm to 30mm thick and required width in plain/ diamond pattern on bed of 1:6 C. M. including cement float, filling joints with neat cement slurry, curing, polishing and cleaning etc. complete.. Spec. No. Bd.M.3 Page 1 No.380.SSR I.No.33.06, Sr.No.993 P.No.213	42.340	1252.79	Sqm	53043.00
	Ground Floor				
19	Providing and laying machine cut machine polished machine cut Kota stone slabs 20 to 25 mm thick for treads and risers of steps and staircases, with rounded nosing for the treads on a bed of 1:4 cement mortar including cement float, filling joints with neat cement slurry, curing, polishing and cleaning etc. complete.. Spec No.:As directed by Engineer in charge. SSR I.No.33.18, Sr.No.1005, P.214	12.000	1577.26	Sqm	18927.00
	Ground Floor				
20	Providing and laying chequered tiles of approved quality of size 30 cm x 30 cm, confirming to corresponding I.S. for flooring in required position laid on a bed of 1:4 cement mortar including cement float, filling joint with cement slurry cleaning curing etc. complete.. Spec No.:Bd. M-12 page Number 385. SSR I.No.33.66, Sr.No.1050, P.220	6.000	740.26	Sqm	4442.00
	Ground Floor				
Oil Painting					
21	Providing and applying 2 coats of 100% Pure acrylic low VOC and APEO & HCHO free water based paint of approved colour that belongs to class 1 flame spread resistance of approved make Paint should provide durable and long lasting silk finish with a high crack tolerance of upto 1mm. Paint should have an	74.600	308.00	Sqm	22977.00
	Ground Floor				
22	Providing and applying 2 Coats of 100% Pure acrylic water based paint with special heat reflectance property to withstand the harsh climate for period of atleast 10 years of approved make. Paint system should provide durable and long lasting finish with DFT of min 90 microns and should protect against concrete carbonation with R value of minimum 600 and equivalent concrete layer thickness value of min 150 cm. Paint should have breathability property and should be able to cover hairline cracks in the surface upto 0.5mm The paint has to be applied on a coat of high quality acrylic copolymer based alkali resistant primer with excellent penetrating properties including cleaning, with all leads and lifts at all levels etc complete, as directed by Engineer in charge..Spec. No. : As directed by Engineer in charge. SSR I.No.48.12, Sr.No.1631, P.No.311 (SSR 2022-23 GREEN BUILDING)	133.200	200.00	Sqm	26640.00
	Ground Floor				
23	Providing and applying two coats of synthetic enamel paint of approved colour to new /old structural steel work and wood work in buildings, including scaffolding if necessary, cleaning and preparing the surface (excluding primer coat) etc. complete. Spec. No. Bd.0.5 Page 1 No. 405..SSR I.No.35.07, Sr.No.1077 P.No.227	39.600	96.00	Sqm	3802.00
	Ground Floor				
Doors & Windows					
24	Providing and fixing rolling shutter fabricated from steel laths of minimum thickness 0.9 mm with lock plate of 3.15 mm thickness reinforced with 35 x 35 x 5 mm angle section fitted with sliding bolts and handles for both sides, deep M.S. channel section of depth and thickness not less than 65 mm and 3.15 mm respectively with hold fast arrangements, M.S. Bracket plate 300 x 300 x 3.15 mm minimum size and shape with square bar, suspension shaft of minimum 32 mm diameter, hood cover of M.S. sheet not less than 0.9 mm thickness and of any size at top and safety devices including mechanical gear operation arrangement consisting of worm gear wheels and worms of high grade cast iron or mild steel and one coat of red lead primer etc. complete. (I.S. 62481979) (With mechanical gear) (I.S. 62481979) (With mechanical gear) Spec.No.BD-T-55 Page Number 510 SSR I.No.39.25, Sr.No.1218 P.No.249	39.600	5308.00	Sqm	210197.00
	Ground Floor				

Abstract

Item No.	Item Of Work.	Qty.	Rate	Unit	Amount
25	Providing and fixing in position powder coated aluminium louvered windows / ventilator of various sizes with powder coating as per detailed drawing and specifications including aluminium frames 80 x 38 mm x 1.22 mm box type, 5 mm thick sheet glass louvers, of approved quality etc. complete..Spec. No. : As directed by Engineer in charge. SSR I.No.39.68, Sr.No.1263 P.No.259				
	Ground Floor	12.600	3467.00	Sqm	43684.00
	Miscellaneous				
26	Providing preconstructional antitermite treatment as per I.S. 6313 (Part-II) by treating the bottom surface and sides of excavation at the rate of 5 litres of emulsion concentrate of 1.0 percent of chlorophyrifos per square meter of surface area covering 10 years guarantee on bond paper...Spec. No. As directed by Engineer in Charge. SSR I.No.21.22, Sr.No.737, P.No.155				
	Ground Floor	256.960	107.00	No	27495.00
27	Providing preconstructional antitermite treatment as per I.S. 6313 (Part-II) by treating the top surface of plinth filling at the rate of 5 litres of emulsion concentrate at 1.0 percent of chlorophyrifos per One Square Metre of surface area covering ten years guarantee on bond paper... Spec. No. As directed by Engineer in charge. SSR I.No.21.24, Sr.No.739 P.No.156				
	Ground Floor	326.456	108.00	No	35257.00
28	Providing and fixing of colour coated Zinc aluminium (R) AZ150 (min 150 gms/sq.mt.total on each side) profiled sheets for roofing. The feed material is manufactured out of nominal 0.45 mm Base Metal Thickness (BMT) (0.5 mm TCT), Hi-strength steel with min.550 MPa yield strength, metallic hot dip coated with Aluminium-Zinc alloy (55% aluminium 43.4% zinc 1.6% silicon) with COLORBOND (R) steel quality super durable polyester paint coat (with inorganic pigment). The paint shall have a total coating thickness of nominal 35 um, comprising of nominal 25um exterior coat on top surface and nominal 10 um reverse coat on back surface. Profile sheet shall have nom. 9501050 mm effective cover width and nominal 25-30 mm deep ribs with subtle square fluting in the five pan at nominal 180-250 mm center- to-center. The end rib shall be designed for anti-capacity groove. and return leg. The feed material should have coil manufacturers product details marked a regular interval. including fasteners with min.fastened with min. 25 um Zinc-Tin alloy coated, Hex head, self-drilling screw etc.complete. (weight of profile 4.52 Kilogram/ One Square Metre) 900 mm girth (Surface Width). Spec. No. As directed by Engineer in Charge. SSR I.No.38.36, Sr.No.1176, P.No.237				
	Ground Floor	681.390	1183.73	Sqm	806582.00
29	Providing and fixing valley gutter of 22 B.W.G. (0.8 mm) plain galvanised iron sheets 120 cm wide with teak wood planking 20 mm thick including two coats of coal-tarring the upper surface of plank etc. complete. (excluding painting to underside of plank). Spec. No. As directed by Engineer in Charge Spec. No. Bd. R. 10, Page Number 455. SSR I.No.38.08, Sr.No.1148 P.No.233				
	Ground Floor	40.460	2926.00	Rgm	118386.00
30	Providing and fixing 22 B.W.G. plain galvanised iron sheets on top of weather shed, including scaffolding, fixing by means of nut and bolts or as directed etc. complete.(Brackets of 70 x 45 mm to be paid separately) Spec No. As directed by Engineer Incharge. SSR I.No.39.88, Sr.No.1283, P.No.263				
	Ground Floor	42.344	1052.00	Sqm	44546.00
31	Royalty Charges-as per statement attached				
	For Sand	179.040	237.00	Cum	42432.00
	For Hard Murum	130.090	216.18	Cum	28123.00

Abstract

Item No.	Item Of Work.	Qty.	Rate	Unit	Amount
Quality Control Charges Items.					
1) Basic Test of Cement					
32	Carrying out basic tests on cement for standard consistency, Fineness, Specific gravity, Setting time (Initial and Final), Compressive strength, Soundness. Spec. No. As directed by Engineer in Charge. SSR I.No.1 P.No.360				
	Ground Floor	1.000	3770.00	/ Test	3770.00
4) Basic Test of Concrete					
33	Carrying out basic tests on Concrete cubes for compressive strength.Spec.No.As directed by Engineer in Charge.SSR I.No.20 P.No.387				
	Ground Floor	7.000	690.00	/ Test	4830.00
34	Carrying out basic tests on T.M.T.Steel (Bar testing upto 16 mm) for Tensile strength,% Elongation,Yield stress,Weight /m,Bend/rebend test.proof test.Spec.No.As directed by Engineer in Charge.SSR I.No.90 P.No.364.				
	Ground Floor	1.000	1275.00	/ Test	1275.00
Total Rs :=					4201265.0



**JV Structural
 Engineers & Consultants
 Aurangabad**

Measurement

Name of Work :- Proposed Construction of Shed for Cattle Feed Units, Storage of Raw Materials & Cattle Feed for Atulniya Farmers Producer Company Ltd. Waregaon Tq. Phulambri Dist.

Measurement Sheet

Item No.	Item Of Work.	Nos.	Length.	Breadth.	Height.	Quantity.	Unit.
1. Excavation							
1	Excavation for foundation in earth, soil of all types, sand, gravel and soft murum, including removing the excavated material up to a distance of 50 m. beyond the building area and stacking and spreading as directed, dewatering, preparing the bed for the foundation and necessary back filling, ramming, watering including shoring and strutting etc. complete. (Lift upto 1.5 m.) By Mechanical Means. Bd.A.1 Page 1 Number 259. SSR I.No. 21.02, Sr.No.721, P.No.153						
Ground Floor							
Total Footings (14 Nos)							
	Group no.1 (FC1)	10	2.400	1.800	0.600	25.920	
	Group no.2 (FC2)	4	1.900	1.600	0.600	7.300	
External Ground beam							
	1-2	1	4.486	0.43	0.300	0.580	
	2-3	1	4.564	0.43	0.300	0.590	
	3-4	1	4.555	0.43	0.300	0.590	
	4-5	1	4.495	0.43	0.300	0.580	
	10-11	1	4.486	0.43	0.300	0.580	
	11-12	1	4.564	0.43	0.300	0.590	
	12-13	1	4.555	0.43	0.300	0.590	
	13-14	1	4.495	0.43	0.300	0.580	
	1-6	1	4.320	0.43	0.300	0.560	
	6-8	1	4.697	0.43	0.300	0.610	
	8-10	1	4.323	0.43	0.300	0.560	
	5-7	1	4.320	0.43	0.300	0.560	
	7-9	1	4.697	0.43	0.300	0.610	
	9-14	1	4.323	0.43	0.300	0.560	
	Ramp	1	3.000	2.00	0.300	1.800	
Net Qty. For Ground Floor						43.160	Cum

2	Excavation for foundation in hard murum including removing the excavated material upto distance of 50 metres beyond the building area and stacking and spreading as directed, dewatering, preparing the bed for the foundation and necessary back filling, ramming, watering including shoring and strutting etc. complete. (Lift upto 1.50 m) By Mechanical Means Spec.No.: Bd.A.2 Page 1 Number 259 SSR I.No.21.06, Sr.No.725 P.No.153						
Ground Floor							
Total Footings (14 Nos)							
	Group no.1 (FC1)	10	2.40	1.800	0.600	25.920	
	Group no.2 (FC2)	4	1.90	1.600	0.600	7.300	
Net Qty. For Ground Floor						33.220	Cum

Measurement

Item No.	Item Of Work.	Nos.	Length.	Breadth.	Height.	Quantity.	Unit.
3	Excavation for foundation in hard murum and boulders including removing the excavated material up to a distance 50 metres, beyond the building area and stacking and spreading as directed, dewatering, preparing the bed for the foundation and necessary back filling, ramming, watering including shoring and strutting etc. complete. (Lift upto 1.5m.) By Mechanical Means Spec. No. Bd.A.3 Page Number 259. SSR I.No. 21.10, Sr.No.728, P.No.154						
Ground Floor							
Total Footings (14 Nos)							
	Group no.1 (FC1)	10	2.40	1.800	0.300	12.960	
	Group no.2 (FC2)	4	1.90	1.600	0.300	3.650	
Net Qty. For Ground Floor						16.610	Cum
4	Filling in plinth and floors with contractors material/brought from outside and approved by Engineer incharge in layers of 15 cm to 20 cm including watering and compaction etc. complete.. Spec. No. Bd.A.11 Page 1 Number 263. SSR I.No. 21.37, Sr.No. 751, P.No. 157						
Ground Floor							
Total Footings (14 Nos)							
	Group no.1 (FC1)	10	2.400	1.800	1.800	77.760	
	Group no.2 (FC2)	4	1.900	1.600	1.800	21.890	
Total Excavation Qty. (A) =						99.650	Cum
	Qty. As Per Item No. 2 (Hard Murum)	1	33.220	1.000	1.000	33.220	
	Qty. As Per Item No. 3 (Hard Murum Boulders)	1	16.610	1.000	1.000	16.610	
	Qty as per - 1:2:4 PCC Below Footing	1	8.300	1.000	1.000	8.300	
	Qty as per - M-20 RCC footing	1	22.640	1.000	1.000	22.640	
	Qty as per - 20 RCC Col. upto GL	1	3.050	1.000	1.000	3.050	
Total Deduction Qty. (B) =						83.820	Cum
Total Filling Required (A)-(B) =						15.830	Cum
Under Flooring							
Ht = 0.60 - 0.10 - 0.15 = 0.350m.							
	Godown Flooring	1	19.54	14.54	0.350	99.439	
	Loading Platform	4	5.29	2.00	0.350	14.820	
Net Qty. For Ground Floor						130.090	Cum
5	Providing soling using 80 mm size trap metal in 15 cm. layer including filling voids with Crushed sand/grit, ramming, watering etc. complete.. Spec. No. As directed by Engineer in charge. SSR I.No. 21.40, Sr.No. 754, P.No. 157						
Ground Floor							
Below Flooring							
	Godown Flooring	1	19.540	14.540	0.150	42.620	
	Loading Platform	4	5.293	2.000	0.150	6.350	
	Ramp	1	3.000	2.000	0.150	0.900	
Net Qty. For Ground Floor						49.870	Cum

Measurement

Item No.	Item Of Work.	Nos.	Length.	Breadth.	Height.	Quantity.	Unit.
----------	---------------	------	---------	----------	---------	-----------	-------

2. Structural Steel Work							
6	Providing structural steel work in trusses, other similar trussed purlins and members with all bracing, gusset plates etc. as per detailed designs and drawings or as directed including cutting, fabricating, hoisting, erecting fixing in position, Making riveted/ bolted/ welded connection and one coat of anticorrosive paint and over it 2 coats of oil painting approved quality and shade etc. complete. Spec. No. Bd.C.2 Page Number 275 SSR I.No.23.04, Sr.No.819, P.No.173						
Ground Floor							
	Truss, Steel Column & Steel Beams	1	7500.00	1.000	1.000	7500.000	Kg
Total Qty						7500.00	Kg
Net Qty. For Ground Floor						7.500	M.T.

3. Plain Cement Concrete							
7	Providing and laying Cast in situ/Ready Mix cement concrete in M-10 of trap/ granite/ quartzite/ gneiss metal for foundation and bedding including bailing out water, Steel centering, formwork, laying/pumping, compacting, roughening them if special finish is to be provided, finishing if required and curing complete, with fully automatic micro processor based PLC with SCADA enabled reversible Drum Type mixer/concrete Batch mix plant (Pan mixer) etc. complete. With fine aggregate (Crushed sand VSI Grade) Spec. No. Bd.E.1 Page 1 No. 287.SSR I.No.24.01, Sr.No.827, P.No.175						
Ground Floor							
Below Flooring							
	Godown Flooring	1	19.540	14.540	0.100	28.411	
	Loading Platform	4	5.293	2.000	0.100	4.234	
	Ramp	1	3.000	2.000	0.100	0.600	
Net Qty. For Ground Floor						33.250	Cum

8	Providing and laying Cast in situ/Ready Mix cement concrete in M15 of trap/ granite/quartzite/gneiss metal for bed blocks, foundation blocks and such other items including bailing out water, Steel centering, formwork, laying/ pumping, compacting, roughening them if special finish is to be provided, finishing uneven and honeycombed surface and curing etc. complete. The Cement Mortar 1:3 plaster is considered for rendering uneven and honeycombed surface only. Newly laid concrete shall be covered by gunny bag, plastic, tarpaulin etc. (Wooden centering will not be allowed.), with fully automatic micro processor based PLC with SCADA enabled reversible Drum Type mixer/ concrete Batch mix plant (Pan mixer) etc. complete. With fine aggregate (Crushed sand VSI Grade) Sepc. No. Bd.E.4 Page Number 289 and B7, Page Number38. SSR I.No. 24.08, Sr.No. 830, P.176						
Ground Floor							
Total Footings (14 Nos)							
	Group no.1 (FC1)	10	2.400	1.800	0.150	6.480	
	Group no.2 (FC2)	4	1.900	1.600	0.150	1.820	
Net Qty. For Ground Floor						8.300	Cum

Measurement

Item No.	Item Of Work.	Nos.	Length.	Breadth.	Height.	Quantity.	Unit.
9	Providing and laying in situ cement concrete M20 with tremix treatment for 100 mm thickness for flooring with groove cutting of 4mm wide and 20mm deep with necessary refilling with bitumen etc. complete. Sepe. No. As directed by Engineer in charge. SSR I.No. 33.30, Sr.No. 1017, P.216						
Ground Floor							
	Godown Flooring	1	19.540	14.540	-	284.112	
Net Qty. For Ground Floor						284.110	Sqm
Reinforcement Cement Concrete							
10	Providing and laying in situ /Ready Mix cement concrete M-20 of trap / granite /quartzite/ gneiss metal for R.C.C. work in foundations like raft, strip foundations, grillage and footings of R.C.C. columns and steel stanchions etc. including bailing out water, Steel centering formwork, laying/pumping cover blocks, compaction and curing roughening the surface if special finish is to be provided (Excluding reinforcement and structural steel) etc. complete, with fully automatic micro processor based PLC with SCADA enabled reversible Drum Type mixer/ concrete Batch mix plant (Pan mixer) etc. complete. With fine aggregate (Crushed sand VSI Grade) Spec. No.Bd.F.3 Page 1 No. 298 and B.7, Page No.38. SSR I.No.25.11, Sr.No.836 P.No.178						
Ground Floor							
	Total Footings (14 Nos)						
	Group no.1 (FC1)	10	2.100	1.500	0.600	18.900	
	Group no.2 (FC2)	4	1.600	1.300	0.450	3.740	
Net Qty. For Ground Floor						22.640	Cum
11	Providing and laying Cast in situ/Ready Mix cement concrete M-20 of trap / granite /quartzite/ gneiss metal for R.C.C. columns as per detailed designs and drawing or as directed including steel centering, formwork, cover blocks, laying/pumping, compaction finishing the formed surfaces with cement mortar 1:3 of sufficient minimum thickness to give a smooth and even surface or roughening if special finish is to be provided and curing etc. complete.(Excluding reinforcement and structural steel).with fully automatic micro processor based PLC with SCADA enabled reversible Drum Type mixer/ concrete Batch mix plant (Pan mixer) etc. complete. With fine aggregate (Crushed sand VSI Grade) Spec. No. : Bd.F.5 Page No. 300 and B.7, Page.No. 38.SSR I.No.25.31, Sr.No.841, P.No.179						
Ground Floor							
Column upto GL							
	Group no.1 (FC1)	10	0.380	0.600	1.050	2.390	
	Group no.2 (FC2)	4	0.230	0.600	1.200	0.660	
Column GL to FFL Ht. 0.600							
	Group no.1 (FC1)	10	0.380	0.600	0.600	1.370	
	Group no.2 (FC2)	4	0.230	0.600	0.600	0.330	
Column FFL to 1.20m Ht.							
	Group no.1 (FC1)	10	0.380	0.600	1.200	2.740	
	Group no.2 (FC2)	4	0.230	0.600	1.200	0.660	
Net Qty. For Ground Floor						8.150	Cum

Measurement

Item No.	Item Of Work.	Nos.	Length.	Breadth.	Height.	Quantity.	Unit.
12	Providing and laying Cast in situ/Ready Mix cement concrete M-20 of trap / granite /quartzite/ gneiss metal for R.C.C. beams and lintels as per detailed designs and drawings or as directed including steel centering, formwork, cover blocks, laying/pumping, compaction and roughening the surface if special finish is to be provided and curing etc. complete. (Excluding reinforcement and structural steel). with fully automatic micro processor based PLC with SCADA enabled reversible Drum Type mixer/ concrete Batch mix plant (Pan mixer) etc. complete. With fine aggregate (Crushed sand VSI Grade) Spec. No. Bd.F.6 Page Number 300 and B.7, Page 1 Number 38 Page.No. 38.SSR I.No.25.50, Sr.No.846, P.No.181						
Ground Floor							
External Plinth beam total 18 Nos							
PB- (230 X 450) 14 NOS							
1-2		1	4.486	0.230	0.450	0.460	
2-3		1	4.564	0.230	0.450	0.470	
3-4		1	4.555	0.230	0.450	0.470	
4-5		1	4.495	0.230	0.450	0.470	
10-11		1	4.486	0.230	0.450	0.460	
11-12		1	4.564	0.230	0.450	0.470	
12-13		1	4.555	0.230	0.450	0.470	
13-14		1	4.495	0.230	0.450	0.470	
1-6		1	4.320	0.230	0.600	0.600	
6-8		1	4.697	0.230	0.600	0.650	
8-10		1	4.323	0.230	0.600	0.600	
5-7		1	4.320	0.230	0.600	0.600	
7-9		1	4.697	0.230	0.600	0.650	
9-14		1	4.323	0.230	0.600	0.600	
Net Qty. For Ground Floor						7.440	Cum

13	Providing and fixing in position TMT - FE - 500 bar reinforcement of various diameters for R.C.C. pile caps, footings, foundations, slabs, beams columns, canopies, staircase, newels, chajjas, lintels pardis, copings, fins, arches etc. as per detailed designs, drawings and schedules. including cutting, bending, hooking the bars, binding with wires or tack welding and supporting as required complete.. Spec.No. Bd.F.17, Page 1 No. 306. SSR I.No.26.33, Sr.No.871, P.No.188						
Ground Floor							
	Qty. As Per Item. No. 11 M20 Footing		22.640	30.00	Kg/Cum	679.20	
	Qty. As Per Item. No. 12 M20 Column		8.150	180.00	Kg/Cum	1467.00	
	Qty. As Per Item. No. 13 M20 Beams		7.440	180.00	Kg/Cum	1339.20	
						Total Qty. =	3485.40 Kg.
Net Qty. For Ground Floor						3.490	/M.T.

Measurement

Item No.	Item Of Work	Nos.	Length.	Breadth.	Height.	Quantity.	Unit.
Brick Work							
14	Providing fly ash brick masonry with conventional / I.S. type fly ash bricks in C.M. 1:6 in foundation and plinth including bailing out water manually striking joints, racking out joints watering and scaffolding etc. complete..Spec. No. As director by engineer in charge and BDG- 2 and 5. SSR I.No.27.12, Sr.No.899 P.No.198						
Ground Floor							
External plinth beam (Plinth Ht = 0.60 - 0.3 = 0.30 m.)							
	1-2	1	4.486	0.230	0.300	0.310	
	2-3	1	4.564	0.230	0.300	0.310	
	3-4	1	4.555	0.230	0.300	0.310	
	4-5	1	4.495	0.230	0.300	0.310	
	10-11	1	4.486	0.230	0.300	0.310	
	11-12	1	4.564	0.230	0.300	0.310	
	12-13	1	4.555	0.230	0.300	0.310	
	13-14	1	4.495	0.230	0.300	0.310	
	1-6	1	4.320	0.230	0.300	0.300	
	6-8	1	4.697	0.230	0.300	0.320	
	8-10	1	4.323	0.230	0.300	0.300	
	5-7	1	4.320	0.230	0.300	0.300	
	7-9	1	4.697	0.230	0.300	0.320	
	9-14	1	4.323	0.230	0.300	0.300	
	Laoding Platform	8	2.000	0.230	0.600	2.210	
		4	4.833	0.230	0.600	2.670	
	Entrance step	4	2.000	0.300	0.150	0.360	
		4	2.000	0.300	0.300	0.720	
		4	2.000	0.300	0.450	1.080	
		4	2.000	0.300	0.600	1.440	
Net Qty. For Ground Floor						12.800	Cum

Measurement

Item No.	Item Of Work.	Nos.	Length.	Breadth.	Height.	Quantity.	Unit.
15	Providing fly ash brick masonry with conventional/ I.S. type bricks in cement mortar 1:6 in superstructure including striking joints, raking out joints, watering and scaffolding etc. Complete. Spec. No. As directed by engineer incharge and BDG- 2 and 5. SSR I.No.27.13, Sr.No.900 P.No.198						
	Ground Floor						
	230mm Thick Brick Wall						
	Ht = 1.20 m.						
	1-2	1	4.486	0.230	1.200	1.240	
	2-3	1	4.564	0.230	1.200	1.260	
	3-4	1	4.555	0.230	1.200	1.260	
	4-5	1	4.495	0.230	1.200	1.240	
	10-11	1	4.486	0.230	1.200	1.240	
	11-12	1	4.564	0.230	1.200	1.260	
	12-13	1	4.555	0.230	1.200	1.260	
	13-14	1	4.495	0.230	1.200	1.240	
	1-6	1	4.320	0.230	1.200	1.190	
	6-8	1	4.697	0.230	1.200	1.300	
	8-10	1	4.323	0.230	1.200	1.190	
	5-7	1	4.320	0.230	1.200	1.190	
	7-9	1	4.697	0.230	1.200	1.300	
	9-14	1	4.323	0.230	1.200	1.190	
	Deduction						
	RS	-4	3.000	0.230	1.200	-3.310	

Net Qty. For Ground Floor	14.050	Cum
----------------------------------	---------------	------------

Plastering & Pointing							
16	Providing internal cement plaster 12mm thick in single coat in cement mortar 1:5 without neeru finish to concrete or brick surfaces, in all positions including scaffolding and curing etc. complete Spec. No. : Bd.L.4 Page 1 No. 368. SSR I.No.32.03, Sr.No.957, P.No.209						
	Ground Floor						
	Internal walls Ht = 1.20 m.						
	Walls	2	19.54	-	1.200	46.900	
		2	14.54	-	1.200	34.900	
	Deduction						
	RS	-4	3.000	-	1.200	-14.400	
	Deduction qty 1/2 X 28.62 = 14.31	1	14.400	0.500	-	7.200	

Net Qty. For Ground Floor	74.600	Sqm
----------------------------------	---------------	------------

Measurement

Item No.	Item Of Work.	Nos.	Length.	Breadth.	Height.	Quantity.	Unit.
17	Providing sand faced plaster externally in cement mortar using approved screened sand, in all positions including base coat of 15 mm thick in cement mortar 1:4 using waterproofing compound at 1 Kilogram per cement bag curing the same for not less than 2 days and keeping the surface of the base coat rough to receive the sand faced treatment 6 to 8 mm thick in cement mortar 1:4 finishing the surface by taking out grains and curing for fourteen days scaffolding etc. complete. Spec. No. : Bd.L.7 Page 1 No. 369. SSR I.No.32.11, Sr.No.963, P.No.209						
Ground Floor							
	External walls (Ht = 1.80 m.)						
	L/W	2	20.000	-	1.800	72.000	
	S/W	2	15.000	-	1.800	54.000	
	Deductions						
	RS	-4	-3.00	-	1.200	14.400	
	Deduction qty 1/2 X 28.62 = 14.31	1	-14.400	0.500	-	-7.200	
Net Qty. For Ground Floor						133.200	Sqm
Paving, Flooring & Dado							
18	Providing and laying machine cut machine Polished Kota stone flooring 25mm to 30mm thick and required width in plain/ diamond pattern on bed of 1:6 C. M. including cement float, filling joints with neat cement slurry, curing, polishing and cleaning etc. complete.. Spec. No. Bd.M.3 Page 1 No.380.SSR I.No.33.06, Sr.No.993 P.No.213						
Ground Floor							
	Loading Platform	4	5.293	2.000	-	42.340	
Net Qty. For Ground Floor						42.340	Sqm
19	Providing and laying machine cut machine polished machine cut Kota stone slabs 20 to 25 mm thick for treads and risers of steps and staircases, with rounded nosing for the treads on a bed of 1:4 cement mortar including cement float, filling joints with neat cement slurry, curing, polishing and cleaning etc. complete.. Spec No.:As directed by Engineer in charge. SSR I.No.33.18, Sr.No.1005, P.214						
Ground Floor							
	Entrance step						
	Tread	12	2.00	0.300	-	7.200	
	Riser	16	2.00	0.150	-	4.800	
Net Qty. For Ground Floor						12.000	Sqm
20	Providing and laying chequered tiles of approved quality of size 30 cm x 30 cm, conforming to corresponding I.S. for flooring in required position laid on a bed of 1:4 cement mortar including cement float, filling joint with cement slurry cleaning curing etc. complete.. Spec No.:Bd. M-12 page Number 385. SSR I.No.33.66, Sr.No.1050, P.220						
Ground Floor							
	Over Ramp	1	3.00	2.000	-	6.000	
Net Qty. For Ground Floor						6.000	Sqm

Measurement

Item No.	Item Of Work.	Nos.	Length.	Breadth.	Height.	Quantity.	Unit.
	Oil Painting						
21	Providing and applying 2 coats of 100% Pure acrylic low VOC and APEO & HCHO free water based paint of approved colour that belongs to class 1 flame spread resistance of approved make Paint should provide durable and long lasting silk finish with a high crack tolerance of upto 1mm. Paint should have						
	Ground Floor						
	Qty. As Per Item No. 34 (For Wall)	1	74.60	1.000	-	74.600	
Net Qty. For Ground Floor						74.600	Sqm

22	Providing and applying 2 Coats of 100% Pure acrylic water based paint with special heat reflectance property to withstand the harsh climate for period of atleast 10 years of approved make. Paint system should provide durable and long lasting finish with DFT of min 90 microns and should protect against concrete carbonation with R value of minimum 600 and equivalent concrete layer thickness value of min 150 cm. Paint should have breathability property and should be able to cover hairline cracks in the surface upto 0.5mm The paint has to be applied on a coat of high quality acrylic copolymer based alkali resistant primer with excellent penetrating properties including cleaning, with all leads and lifts at all levels etc complete, as directed by Engineer in charge. Spec. No. : As directed by Engineer in charge. SSR I.No.48.12, Sr.No.1631, P.No.311 (SSR 2022-23 GREEN BUILDING)						
	Ground Floor						
	Qty. (External Side Plaster)	1	133.20	1.000	-	133.200	
Net Qty. For Ground Floor						133.200	Sqm

23	Providing and applying two coats of synthetic enamel paint of approved colour to new /old structural steel work and wood work in buildings, including scaffolding if necessary, cleaning and preparing the surface (excluding primer coat) etc. complete. Spec. No. Bd.0.5 Page 1 No. 405. SSR I.No.35.07, Sr.No.1077 P.No.227						
	Ground Floor						
	RS	4	3.00	-	3.300	39.600	
Net Qty. For Ground Floor						39.600	Sqm

Doors & Windows							
24	Providing and fixing rolling shutter fabricated from steel laths of minimum thickness 0.9 mm with lock plate of 3.15 mm thickness reinforced with 35 x 35 x 5 mm angle section fitted with sliding bolts and handles for both sides, deep M.S. channel section of depth and thickness not less than 65 mm and 3.15 mm respectively with hold fast arrangements, M.S. Bracket plate 300 x 300 x 3.15 mm minimum size and shape with square bar, suspension shaft of minimum 32 mm diameter, hood cover of M.S. sheet not less than 0.9 mm thickness and of any size at top and safety devices including mechanical gear operation arrangement consisting of worm gear wheels and worms of high grade cast iron or mild steel and one coat of red lead primer etc. complete. (I.S. 62481979) (With mechanical gear) (I.S. 62481979) (With mechanical gear) Spec.No.BD-T-55 Page Number 510 SSR I.No.39.25, Sr.No.1218 P.No.249						
	Ground Floor						
	RS	4	3.00	-	3.300	39.600	
Net Qty. For Ground Floor						39.600	Sqm

Measurement

Ite m No.	Item Of Work.	Nos.	Length.	Breadth.	Height.	Quantity.	Unit.
25	Providing and fixing in position powder coated aluminium louvered windows / ventilator of various sizes with powder coating as per detailed drawing and specifications including aluminium frames 80 x 38 mm x 1.22 mm box type, 5 mm thick sheet glass louvers, of approved quality etc. complete..Spec. No. : As directed by Engineer in charge. SSR I.No.39.68, Sr.No.1263 P.No.259						
	Ground Floor						
	V	20	0.60	-	0.600	7.200	
	V1	20	0.45	-	0.600	5.400	

Net Qty. For Ground Floor	12.600 Sqm
----------------------------------	-------------------

Miscellaneous							
26	Providing preconstructional antitermite treatment as per I.S. 6313 (Part-II) by treating the bottom surface and sides of excavation at the rate of 5 litres of emulsion concentrate of 1.0 percent of chlorophyrifos per square meter of surface area covering 10 years guarantee on bond paper...Spec. No. As directed by Engineer in Charge. SSR I.No.21.22, Sr.No.737, P.No.155						
	Ground Floor						
	Pit Bottom						
	Group no.1 (FC1)	10	2.40	1.800	-	43.200	
	Group no.2 (FC2)	4	1.90	1.600	-	12.160	
	Pit - Sides						
	Footing 14 nos						
	Group no.1 (FC1)	20	2.40	1.800	-	86.400	
		20	1.80	1.800	-	64.800	
	Group no.2 (FC2)	8	1.90	1.800	-	27.360	
		8	1.60	1.800	-	23.040	

Net Qty. For Ground Floor	256.960 Sqm
----------------------------------	--------------------

27	Providing preconstructional antitermite treatment as per I.S. 6313 (Part-II) by treating the top surface of plinth filling at the rate of 5 litres of emulsion concentrate at 1.0 percent of clorophyrifos per One Square Metre of surface area covering ten years guarantee on bond paper... Spec. No. As directed by Engineer in harge. SSR I.No.21.24, Sr.No.739 P.No.156						
	Ground Floor						
	Below Flooring						
	Godown Flooring	1	19.540	14.540	-	284.112	
	Loading Platform	4	5.293	2.000	-	42.344	

Net Qty. For Ground Floor	326.456 Sqm
----------------------------------	--------------------

Measurement

Item No.	Item Of Work.	Nos.	Length.	Breadth.	Height.	Quantity.	Unit.
28	<p>Providing and fixing of colour coated Zinc aluminium (R) AZ150 (min 150 gms/sq.mt.total on each side) profiled sheets for roofing. The feed material is manufactured out of nominal 0.45 mm Base Metal Thickness (BMT) (0.5 mm TCT), Hi-strength steel with min.550 MPa yield strength, metallic hot dip coated with Aluminium-Zinc alloy (55% aluminium 43.4% zinc 1.6% silicon) with COLORBOND (R) steel quality super durable polyster paint coat (with inorganic pigment). The paint shall have a total coating thickness of nominal 35 um, comprising of nominal 25um exterior coat on top surface and nominal 10 um reverse coat on back surface. Profile sheet shall have nom. 9501050 mm effective cover width and nominal 25-30 mm deep ribs with subtle square fluting in the five pan at nominal 180-250 mm center- to-center. The end rib shall be designed for anti-capacity groove. and return leg. The feed material should have coil manufacturers product details marked a regular interval. including fasteners with min.fastened with min. 25 um Zinc-Tin alloy coated, Hex head, self-drilling screw etc.complete. (weight of profile 4.52 Kilogram/ One Square Metre) 900 mm girth (Surface Width). Spec. No. As directed by Engineer in Charge. SSR I.No.38.36, Sr.No.1176, P.No.237</p>						
Ground Floor							
	Sheet For Truss Roof	1	15.000	20.000	-	300.000	
	Front & Back Side Triangle Area (0.5*25.35)	2	9.770	2.950	-	57.640	
	Front and Back Side Wall	2	20.00	-	5.165	206.600	
	Left and Right Side Wall	2	15.00	-	5.165	154.950	
	Deduction						
	RS	-4	3.00	-	2.100	-25.200	
	V	-20	0.60	-	0.600	-7.200	
	VI	-20	0.45	-	0.600	-5.400	
Net Qty. For Ground Floor						681.390	Sqm
29	<p>Providing and fixing valley gutter of 22 B.W.G. (0.8 mm) plain galvanised iron sheets 120 cm wide with teak wood planking 20 mm thick including two coats of coal-tarring the upper surface of plank etc. complete. (excluding painting to underside of plank). Spec. No. As directed by Engineer in Charge Spec. No. Bd. R. 10, Page Number 455. SSR I.No.38.08, Sr.No.1148 P.No.233</p>						
Ground Floor							
	Gutter	2	20.23	-	-	40.460	
Net Qty. For Ground Floor						40.460	Rgm
30	<p>Providing and fixing 22 B.W.G. plain galvanised iron sheets on top of weather shed, including scaffolding, fixing by means of nut and bolts or as directed etc. complete.(Brackets of 70 x 45 mm to be paid separately) Spec No. As directed by Engineer Incharge. SSR I.No.39.88, Sr.No.1283, P.No.263</p>						
Ground Floor							
	Over Loading Platform	4	5.293	2.000	-	42.344	
Net Qty. For Ground Floor						42.344	Sqm

It. No.	Item Of Work.				Unit.
Structural Steel Work					
6	Providing structural steel work in trusses, other similar trussed purlins and members with all bracing, gusset plates etc. as per detailed designs and drawings or as directed including cutting, fabricating, hoisting, erecting fixing in position, Making riveted/ bolted/ welded connection and one coat of anticorrosive paint and over it 2 coats of oil painting approved quality and shade etc. complete. Spec. No. Bd.C.2 Page Number 275 SSR I.No.23.04, Sr.No.819, P.No.173				
	Basic Rate As Per SSR 2022-23				Rs : 119459.00 ✓
	Add Lead Charges For Steel	1	1.00	0.00	Rs : 0.00
Net Amount For Ground Floor					119459.00 /M.T.

Plain Cement Concrete					
7	Providing and laying Cast in situ/Ready Mix cement concrete in M-10 of trap/ granite/ quartzite/ gneiss metal for foundation and bedding including bailing out water, Steel centering, formwork, laying/pumping, compacting, roughening them if special finish is to be provided, finishing if required and curing complete, with fully automatic micro processor based PLC with SCADA enabled reversible Drum Type mixer/concrete Batch mix plant (Pan mixer) etc. complete. With fine aggregate (Crushed sand VSI Grade) Spec. No. Bd.E.1 Page 1 No. 287.SSR I.No.24.01, Sr.No.827, P.No.175				
	Basic Rate As Per SSR 2022-23				Rs : 5830.00
	Deduct 10% For Scada	-1	0.10	5830.00	Rs : -583.00
Sub Total					Rs : 5247.00 /Cum
	Add Lead Charges For 40mm Metal	1	0.70	423.41	Rs : 296.39
	Add Lead Charges For 20mm Metal	1	0.24	441.82	Rs : 106.04
	Add Lead Charges For Sand	1	0.47	263.19	Rs : 123.70
	Add Lead Charges For Cement	1	0.22	0.00	Rs : 0.00
Net Amount For Ground Floor					5773.120 /Cum

8	Providing and laying Cast in situ/Ready Mix cement concrete in M15 of trap/ granite/quartzite/gneiss metal for bed blocks, foundation blocks and such other items including bailing out water, Steel centering, formwork, laying/ pumping, compacting, roughening them if special finish is to be provided, finishing uneven and honeycombed surface and curing etc. complete. The Cement Mortar 1:3 plaster is considered for rendering uneven and honeycombed surface only. Newly laid concrete shall be covered by gunny bag, plastic, tarpaulin etc. (Wooden centering will not be allowed.), with fully automatic micro processor based PLC with SCADA enabled reversible Drum Type mixer/ concrete Batch mix plant (Pan mixer) etc. complete. With fine aggregate (Crushed sand VSI Grade) Sepc. No. Bd.E.4 Page Number 289 and B7, Page Number38. SSR I.No. 24.08, Sr.No. 830, P.176				
	Basic Rate As Per SSR 2022-23				Rs : 6359.00
	Deduct 10% For Scada	-1	0.10	6359.00	Rs : -635.90
Sub Total					Rs : 5723.10 /Cum
	Add Lead Charges For 40mm Metal	1	0.56	423.41	Rs : 237.11
	Add Lead Charges For 20mm Metal	1	0.22	441.82	Rs : 97.20
	Add Lead Charges For 10 / 12mm Metal	1	0.11	441.82	Rs : 48.60
	Add Lead Charges For Sand	1	0.44	263.19	Rs : 115.80
	Add Lead Charges For Cement	1	0.30	0.00	Rs : 0.00
Net Amount For Ground Floor					6221.810 /Cum

Rate Analysis

It. No.	Item Of Work.	Unit.
9	Providing and laying in situ cement concrete M20 with tremix treatment for 100 mm thickness for flooring with groove cutting of 4mm wide and 20mm deep with necessary refilling with bitumen etc. complete. Sepe. No. As directed by Engineer in charge. SSR I.No. 33.30, Sr.No. 1017, P.216	
	Basic Rate As Per SSR 2022-23	Rs : 796.00
	Add Lead Charges For 20mm Metal 1 0.57 441.82	Rs : 251.84
	Add Lead Charges For 10 / 12mm Metal 1 0.28 441.82	Rs : 123.71
	Add Lead Charges For Sand 1 0.425 263.19	Rs : 111.86
	Add Lead Charges For Cement 1 0.40 0.00	Rs : 0.00
Net Amount For Ground Floor		1283.400 /Sqm

Reinforcement Cement Concrete

- 10 Providing and laying in situ /Ready Mix cement concrete M-20 of trap / granite /quartzite/ gneiss metal for R.C.C. work in foundations like raft, strip foundations, grillage and footings of R.C.C. columns and steel stanchions etc. including bailing out water, Steel centering formwork, laying/pumping cover blocks, compaction and curing roughening the surface if special finish is to be provided (Excluding reinforcement and structural steel) etc. complete, with fully automatic micro processor based PLC with SCADA enabled reversible Drum Type mixer/ concrete Batch mix plant (Pan mixer) etc. complete. With fine aggregate (Crushed sand VSI Grade) Spec. No.Bd.F.3 Page 1 No. 298 and B.7, Page No.38. SSR I.No.25.11, Sr.No.836 P.No.178

Basic Rate As Per SSR 2022-23				Rs : 7104.00
Deduct 10% For Scada	-1	0.10	7104.00	Rs : -710.40
Sub Total				Rs : 6393.60 /Cum
Add Lead Charges For 20mm Metal	1	0.570	441.82	Rs : 251.84
Add Lead Charges For 10 / 12mm Metal	1	0.280	441.82	Rs : 123.71
Add Lead Charges For Sand	1	0.425	263.19	Rs : 111.86
Add Lead Charges For Cement	1	0.350	0.00	Rs : 0.00
Net Amount For Ground Floor				Rs : 6881.000 /Cum

- 11 Providing and laying Cast in situ/Ready Mix cement concrete M-20 of trap / granite /quartzite/ gneiss metal for R.C.C. columns as per detailed designs and drawing or as directed including steel centering, formwork, cover blocks, laying/pumping, compaction finishing the formed surfaces with cement mortar 1:3 of sufficient minimum thickness to give a smooth and even surface or roughening if special finish is to be provided and curing etc. complete.(Excluding reinforcement and structural steel).with fully automatic micro processor based PLC with SCADA enabled reversible Drum Type mixer/ concrete Batch mix plant (Pan mixer) etc. complete. With fine aggregate (Crushed sand VSI Grade) Spec. No. : Bd.F.5 Page No. 300 and B.7, Page.No. 38.SSR I.No.25.31, Sr.No.841, P.No.179

Basic Rate As Per SSR 2022-23				Rs : 13783.00
Deduct 10% For Scada	-1	0.10	13783.0	Rs : -1378.30
Sub Total				Rs : 12404.70 /Cum
Add Lead Charges For 20mm Metal	1	0.570	441.82	Rs : 251.84
Add Lead Charges For 10 / 12mm Metal	1	0.280	441.82	Rs : 123.71
Add Lead Charges For Sand	1	0.425	263.19	Rs : 111.86
Add Lead Charges For Cement	1	0.350	0.00	Rs : 0.00
Net Amount For Ground Floor				12892.100 /Cum

Rate Analysis

It. No.	Item Of Work.	Unit.
12	Providing and laying Cast in situ/Ready Mix cement concrete M-20 of trap / granite /quartzite/ gneiss metal for R.C.C. beams and lintels as per detailed designs and drawings or as directed including steel centering, formwork, cover blocks, laying/pumping, compactionand roughening the surface if special finish is to be provided and curing etc. complete. (Excluding reinforcement and structural steel). with fully automatic micro processor based PLC with SCADA enabled reversible Drum Type mixer/ concrete Batch mix plant (Pan mixer) etc. complete. With fine aggregate (Crushed sand VSI Grade) Spec. No. :Bd.F.6 Page Number 300 and B.7, Page 1 Number38 Page.No. 38.SSR I.No.25.50, Sr.No.846, P.No.181	
	Basic Rate As Per SSR 2022-23	Rs : 12269.00
	Deduct 10% For Scada	Rs : -1226.90
	Sub Total	Rs : 11042.10 /Cum
	Add Lead Charges For 20mm Metal	Rs : 251.84
	Add Lead Charges For 10 / 12mm Metal	Rs : 123.71
	Add Lead Charges For Sand	Rs : 111.86
	Add Lead Charges For Cement	Rs : 0.00
	Net Amount For Ground Floor	11529.500 /Cum
13	Providing and fixing in position TMT - FE - 500 bar reinforcement of various diameters for R.C.C. pile caps, footings, foundations, slabs, beams columns, canopies, staircase, newels, chajjas, lintels pardis, copings, fins, arches etc. as per detailed designs, drawings and schedules. including cutting, bending, hooking the bars, binding with wires or tack welding and supporting as required complete.. Spec.No. Bd.F.17, Page 1 No. 306. SSR I.No.26.33, Sr.No.871, P.No.188	
	Basic Rate As Per SSR 2022-23	Rs : 89703.00
	Add Lead Charges For Steel	Rs : 0.00
	Net Amount For Ground Floor	89703.000 /M.T.
Brick Work		
14	Providing fly ash brick masonry with conventional / I.S. type fly ash bricks in C.M. 1:6 in foundation and plinth including bailing out water manually striking joints, racking out joints watering and scaffolding etc. complete..Spec. No. As director by engineer in charge and BDG- 2 and 5. SSR I.No.27.12, Sr.No.899 P.No.198	
	Basic Rate As Per SSR 2022-23	Rs : 6884.00
	Add Lead Charges For Brick	Rs : 574.75
	Add Lead Charges For Sand	Rs : 84.22
	Add Lead Charges For Cement	Rs : 0.00
	Net Amount For Ground Floor	7542.970 /Cum
15	Providing fly ash brick masonry with conventional/ I.S. type bricks in cement mortar 1:6 in superstructure including striking joints, raking out joints, watering and scaffolding etc. Complete. Spec. No. As director by engineer incharge and BDG- 2 and 5. SSR I.No.27.13, Sr.No.900 P.No.198	
	Basic Rate As Per SSR 2022-23	Rs : 7106.00
	Add Lead Charges For Brick	Rs : 574.75
	Add Lead Charges For Sand	Rs : 84.22
	Add Lead Charges For Cement	Rs : 0.00
	Net Amount For Ground Floor	7764.970 /Cum

Rate Analysis

It. No.	Item Of Work.	Unit.
	Oil Painting	
21	Providing and applying 2 coats of 100% Pure acrylic low VOC and APEO & HCHO free water based paint of approved colour that belongs to class 1 flame spread resistance of approved make. Paint should provide durable and long lasting silk finish with a high crack tolerance of upto 1mm. Paint should have an outstanding washability with high resistance to wide range of bacteria and fungus. Paint has to be applied on smooth and uniform surface prepared by an acrylic copolymer low VOC & Odour putty. This surface should be primed with water based low VOC Primer. The work activity should cover all aspects of applying paints from surface preparation as directed by Engineer in charge. SSR I.No.48.11, Sr.No.1630, P.No.311 (SSR 2022-23 GREEN BUILDING)	
	Basic Rate As Per SSR 2022-23 ✓	Rs : 308.00
	Net Amount For Ground Floor	308.000 /Sqm
22	Providing and applying 2 Coats of 100% Pure acrylic water based paint with special heat reflectance property to withstand the harsh climate for period of atleast 10 years of approved make. Paint system should provide durable and long lasting finish with DFT of min 90 microns and should protect against concrete carbonation with R value of minimum 600 and equivalent concrete layer thickness value of min 150 cm. Paint should have breathability property and should be able to cover hairline cracks in the surface upto 0.5mm The paint has to be applied on a coat of high quality acrylic copolymer based alkali resistant primer with excellent penetrating properties including cleaning, with all leads and lifts at all levels etc complete, as directed by Engineer in charge..Spec. No. : As directed by Engineer in charge. SSR I.No.48.12, Sr.No.1631, P.No.311 (SSR 2022-23 GREEN BUILDING)	
	Basic Rate As Per SSR 2022-23 ✓	Rs : 200.00
	Net Amount For Ground Floor	200.000 /Sqm
23	Providing and applying two coats of synthetic enamel paint of approved colour to new /old structural steel work and wood work in buildings, including scaffolding if necessary, cleaning and preparing the surface (excluding primer coat) etc. complete. Spec. No. Bd.0.5 Page 1 No. 405..SSR I.No.35.07, Sr.No.1077 P.No.227	
	Basic Rate As Per SSR 2022-23	Rs : 96.00
	Net Amount For Ground Floor	96.000 /Sqm
	Doors & Windows	
24	Providing and fixing rolling shutter fabricated from steel laths of minimum thickness 0.9 mm with lock plate of 3.15 mm thickness reinforced with 35 x 35 x 5 mm angle section fitted with sliding bolts and handles for both sides, deep M.S. channel section of depth and thickness not less than 65 mm and 3.15 mm respectively with hold fast arrangements, M.S. Bracket plate 300 x 300 x 3.15 mm minimum size and shape with square bar, suspension shaft of minimum 32 mm diameter, hood cover of M.S. sheet not less than 0.9 mm thickness and of any size at top and safety devices including mechanical gear operation arrangement consisting of worm gear wheels and worms of high grade cast iron or mild steel and one coat of red lead primer etc. complete. (I.S. 62481979) (With mechanical gear) (I.S. 62481979) (With mechanical gear) Spec.No.BD-T-55 Page Number 510 SSR I.No.39.25, Sr.No.1218 P.No.249	
	Basic Rate As Per SSR 2022-23	Rs : 5308.00
	Net Amount For Ground Floor	5308.00 /Sqm

Rate Analysis

It. No.	Item Of Work.	Unit.
25	Providing and fixing in position powder coated aluminium louvered windows / ventilator of various sizes with powder coating as per detailed drawing and specifications including aluminium frames 80 x 38 mm x 1.22 mm box type, 5 mm thick sheet glass louvers, of approved quality etc. complete..Spec. No. : As directed by Engineer in charge. SSR I.No.39.68, Sr.No.1263 P.No.259	
	Basic Rate As Per SSR 2022-23	Rs : 3467.00
	Net Amount For Ground Floor	3467.00 /Sqm

Miscellaneous

26	Providing preconstructional antitermite treatment as per I.S. 6313 (Part-II) by treating the bottom surface and sides of excavation at the rate of 5 litres of emulsion concentrate of 1.0 percent of chlorophyrifos per square meter of surface area covering 10 years guarantee on bond paper...Spec. No. As directed by Engineer in Charge. SSR I.No.21.22, Sr.No.737, P.No.155	
	Basic Rate As Per SSR 2022-23	Rs : 107.00
	Net Amount For Ground Floor	107.000 /Sqm

27	Providing preconstructional antitermite treatment as per I.S. 6313 (Part-II) by treating the top surface of plinth filling at the rate of 5 litres of emulsion concentrate at 1.0 percent of chlorophyrifos per One Square Metre of surface area covering ten years guarantee on bond paper... Spec. No. As directed by Engineer in harge. SSR I.No.21.24, Sr.No.739 P.No.156	
	Basic Rate As Per SSR 2022-23	Rs : 108.00
	Net Amount For Ground Floor	108.000 /Sqm

28	Providing and fixing of colour coated Zinc aluminium (R) AZ150 (min 150 gms/sq.mt.total on each side) profiled sheets for roofing. The feed material is manufactured out of nominal 0.45 mm Base Metal Thickness (BMT) (0.5 mm TCT), Hi-strength steel with min.550 MPa yield strength, metallic hot dip coated with Aluminium-Zinc alloy (55% aluminium 43.4% zinc 1.6% silicon) with COLORBOND (R) steel quality super durable polyster paint coat (with inorganic pigment). The paint shall have a total coating thickness of nominal 35 um, comprising of nominal 25um exterior coat on top surface and nominal 10 um reverse coat on back surface. Profile sheet shall have nom. 9501050 mm effective cover width and nominal 25-30 mm deep ribs with subtle square fluting in the five pan at nominal 180-250 mm center- to-center. The end rib shall be designed for anti-capacity groove. and return leg. The feed material should have coil manufacturers product details marked a regular interval. including fasteners with min.fastened with min. 25 um Zinc-Tin alloy coated, Hex head, self-drilling screw etc.complete. (weight of profile 4.52 Kilogram/ One Square Metre) 900 mm girth (Surface Width). Spec. No. As directed by Engineer in Charge. SSR I.No.38.36, Sr.No.1176, P.No.237	
----	--	--

Basic Rate As Per SSR 2022-23	(A) Rs : 1068.00
Add For Turbo ventilator 24". Supply Rate. 4 8680.00 300.000	Rs : 115.73
Building (Bd-R : Roofing and ceiling) Sr.No. 42, Page No.374	

Sub Total	Rs : 1183.730 /Sqm
Net Amount For Ground Floor	Rs. 1183.730 /Sqm

Rate Analysis

It. No.	Item Of Work.	Unit.
29	Providing and fixing valley gutter of 22 B.W.G. (0.8 mm) plain galvanised iron sheets 120 cm wide with teak wood planking 20 mm thick including two coats of coal-tarring the upper surface of plank etc. complete. (excluding painting to underside of plank). Spec. No. As directed by Engineer in Charge Spec. No. Bd. R. 10, Page Number 455. SSR I.No.38.08, Sr.No.1148 P.No.233	
	Basic Rate As Per SSR 2022-23	Rs : 2926.00
	Net Amount For Ground Floor	2926.000 /Rgm
30	Providing and fixing 22 B.W.G. plain galvanised iron sheets on top of weather shed, including scaffolding, fixing by means of nut and bolts or as directed etc. complete.(Brackets of 70 x 45 mm to be paid separately) Spec No. As directed by Engineer Incharge. SSR I.No.39.88, Sr.No.1283, P.No.263	
	Basic Rate As Per SSR 2022-23	Rs : 1052.00
	Net Amount For Ground Floor	1052.000 /Sqm

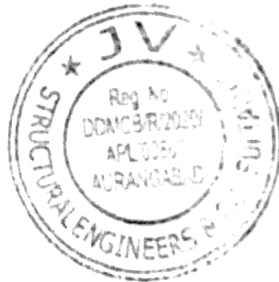

JV Structural
Engineers & Consultants
Aurangabad

Royalty

**Name of Work :- Proposed Construction of Shed for Cattle Feed Units,
Storage of Raw Materials & Cattle Feed for Atulniya Farmers Producer
Company Ltd. Waregaon Tq. Phulambri Dist. Aurangabad**

Royalty Statement

Item	ITEM OF WORK	UNIT	TOTAL QTY.	SAND		SM / HM	
				Cons. Rate	Qty.		
###	Filling in plinth and floors with approved excavated material in 15cm. to 20cm. SSR I.No. 21.36, Sr.No. 743 P.No.152	Cum	130.09	-	-	1.000	130.09
5	Providing soling using 80 mm size trap metal in 15 cm. layer including filling voids with SSR I.No. 21.40, Sr.No. 747, P.No. 152	Cum	49.870	0.150	7.480	-	-
7	Providing and laying Cast in situ/Ready Mix cement concrete in M-10 of trap/ granite/ quartzite/ gneiss metal for foundation SSR I.No.24.01, Sr.No.820, P.No.169	Cum	33.250	0.470	15.630	-	-
8	Providing and laying Cast in situ/Ready Mix cement concrete in M15 of trap/ granite/ quartzite/ gneiss metal for bed blocks, foundation SSR I.No. 24.08, Sr.No. 823, P.169	Cum	8.300	0.440	3.650	-	-
9	Providing and laying in-situ M30 Grade unreinforced plain cement concrete pavement over a prepared sub base SSR I.No. 5.01, Sr.No. 169, P.39	Cum	284.110	0.425	120.750	-	-
10	Providing and laying in situ /Ready Mix cement concrete M-20 of trap / granite /quartzite/ gneiss metal for R.C.C. work in foundations. SSR I.No.25.11, Sr.No.829 P.No.172	Cum	22.640	0.425	9.620	-	-
11	Providing and laying Cast in situ/Ready Mix cement concrete M-20 of trap / granite /quartzite/ gneiss metal for R.C.C. columns SSR I.No.25.31, Sr.No.834, P.No.173						
	Ground Floor	Cum	8.150	0.425	3.460	-	-
12	Providing and laying Cast in situ/Ready Mix cement concrete M-20 of trap / granite /quartzite/ gneiss metal for R.C.C. beams SSR I.No.25.50, Sr.No.839, P.No.175						
	Ground Floor	Cum	7.440	0.425	3.160	-	-

Royalty

14	Providing fly ash brick masonry with conventional / I.S. type fly ash bricks in C.M. 1:6 in foundation and plinth including SSR I.No.27.12, Sr.No.892 P.No.190	Cum	12.800	0.320	4.100	-	-
15	Providing fly ash brick masonry with conventional/ I.S. type bricks in cement mortar 1:6 in superstructure SSRI.No.27.13, Sr.No.893 P.No.190						
	Ground Floor	Cum	14.050	0.320	4.500	-	-
16	Providing internal cement plaster 12mm thick in single coat in cement mortar 1:5 SSRI.No.32.03, Sr.No.950, P.No.201						
	Ground Floor	Sqm	74.600	0.015	1.120	-	-
17	Providing sand faced plaster externally in cement mortar using approved screened SSR I.No.32.11, Sr.No.956 P.No.201						
	Ground Floor	Sqm	133.200	0.0330	4.400	-	-
18	Providing and laying machine cut machine Polished Kota stone flooring 25mm to 30mm thick and required width in plain/ diamond SSR I.No.33.06, Sr.No.986 P.No.205						
	First Floor	Sqm	42.340	0.022	0.930	-	-
19	Providing and laying machine cut machine polished machine cut Kota stone slabs 20 to 25 mm thick for treads and risers of steps SSR I.No.33.18, Sr.No.998, P.207						
	Ground Floor	Sqm	12.000	0.0200	0.240	-	-
TOTAL QTY.						179.04	130.09
RATE OF ROYALTY						237.00	216.18
ROYALTY AMOUNT						42432.00	28123.00

TOTAL QTY. 309.13
TOTAL AMOUNT 70555.00



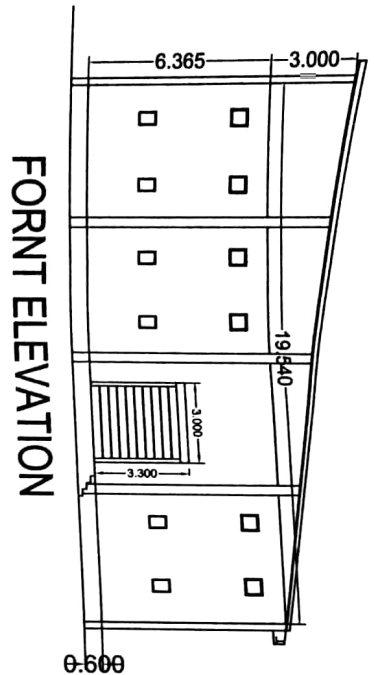

JV Structural
Engineers & Consultants
Aurangabad

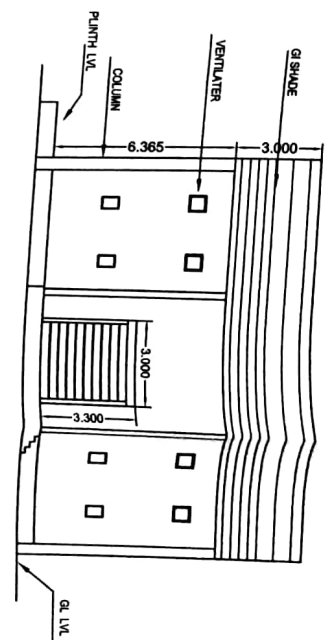

FRONT ELEVATION

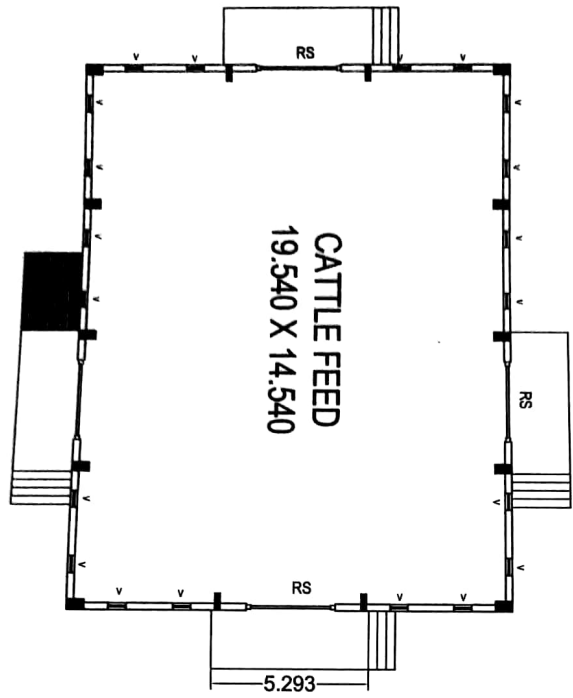

SIDE ELEVATION



SECTION X-X

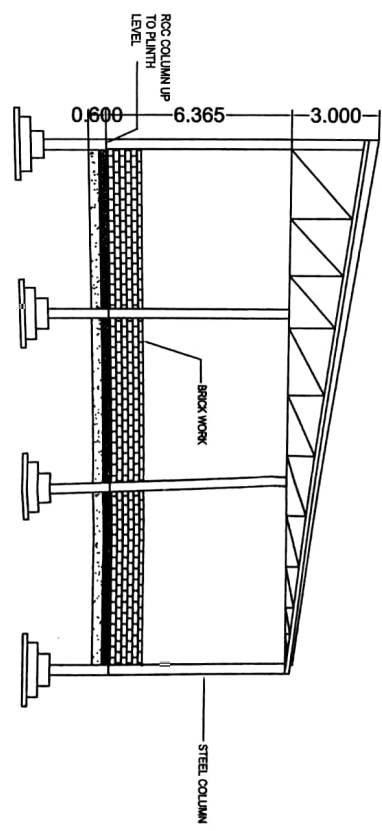

SCHEDULE OF OPENNING

V	-	0.6 X 0.6
V1	-	0.45 X 0.6

CONSULTANT

JV Structural Engineers & Consultants

NAME OF WORK :- PROPOSED CONSTRUCTION OF SHED FOR CATTLE FEED UNITS STORAGE OF RAW MATERIALS & CATTLE FEED FOR ATUNTYA FARMERS PRODUCER COMPANY LTD. WAREGAON TO, PHULAMBRI DIST.

OFFICE :- Plot 311/P Opp Patel Junior College, Hussan Nagar, Beed By Pass Aurangabad.
 Mobile : 9423028563, 9673071706
 Email : jvstructural@rediffmail.com
 EMPANELMENT ON PWD REGION AURANGABAD AS A STRUCTURAL DESIGNERS VIDE CE. LTR NO. CEAD-7/4625 OF DT 31-08-2019

Name of Work :- Proposed Construction of Shed for Cattle Feed Units, Storage of Raw Materials & Cattle Feed for Atulniya Farmers Producer Company Ltd. Waregaon Tq. Phulambri Dist. Aurangabad

LEAD CHART

Sr.No.	Material	Total Lead in km	Pay Load Factor	Rate per Trip	Net Lead Charges/Trip	Remarks
1	Stone/Rubble	17.00	4.70	2540.48	540.53	Sawangi Quarry
2	60 mm & 40 mm metal	17.00	6.00	2540.48	423.41	Sawangi Quarry
3	Metal Below 40 mm	17.00	5.75	2540.48	441.82	Sawangi Quarry
4	Conventional Bricks	22.00	3.105	3741.72 1 brick	1.210 1205.060	Jatwada
5	Conventional Sand	11.00	5.75	1513.34	263.19	Girija River
6	Murum	3.00	6.00	1319.89	219.98	Phulambri
7	Cement	0.00	10.00	0.00	0.00	Phulambri
8	Steel	0.00	10.00	0.00	0.00	Phulambri

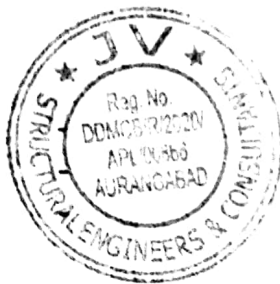

JV Structural
Engineers & Consultants
Aurangabad

Name of Work :- Proposed Construction of Shed for Cattle Feed Units, Storage of Raw Materials & Cattle Feed for Atulniya Farmers Producer Company Ltd. Waregaon Tq. Phulambri Dist. Aurangabad

TRIAL PIT FOR FOUNDATION

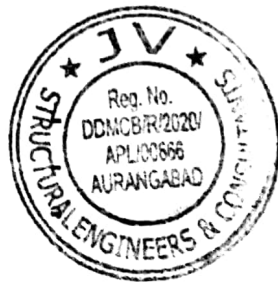
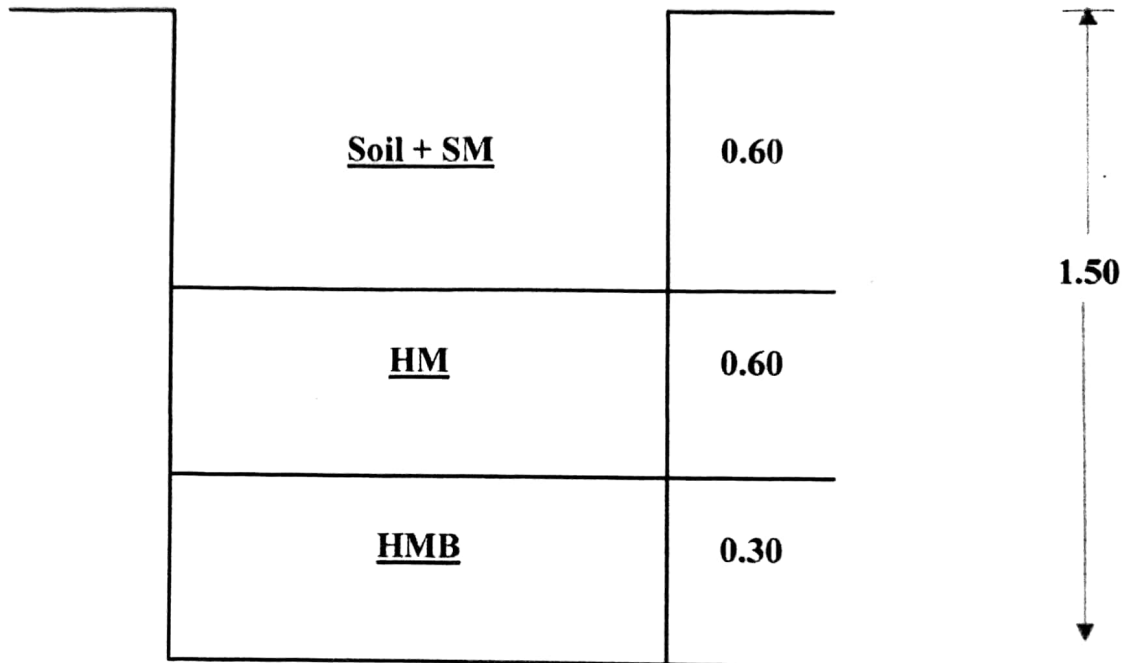

**JV Structural
Engineers & Consultants
Aurangabad**

FOR ESTIMATE PURPOSE ONLY 2

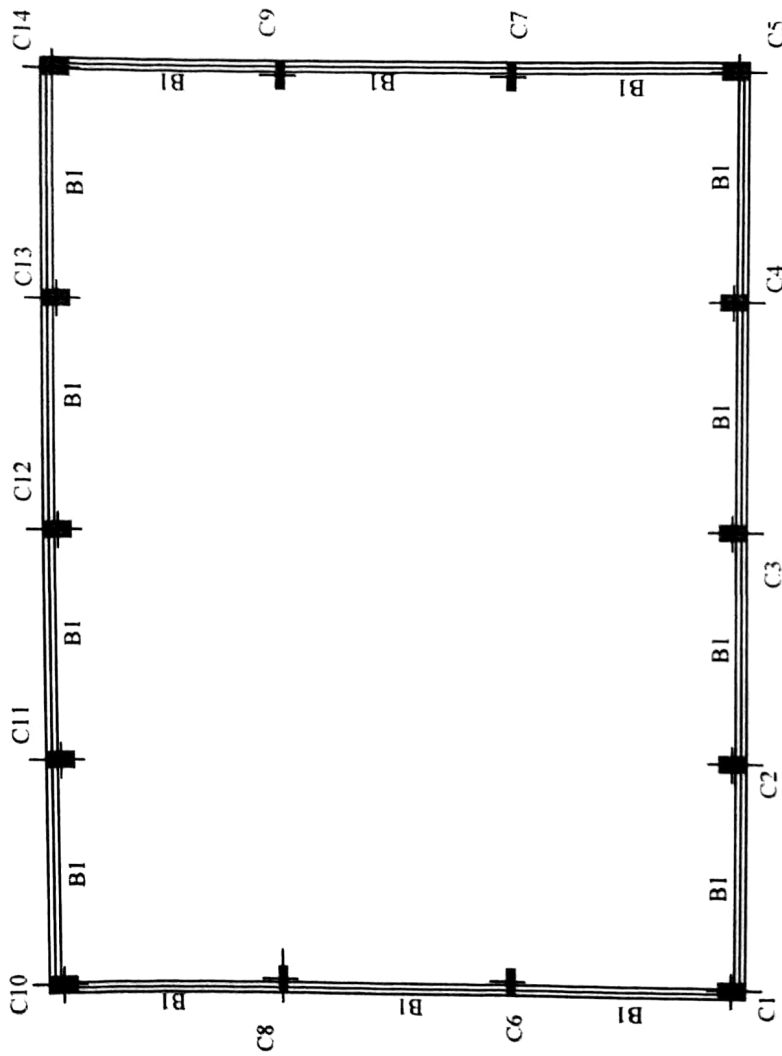

PLINTH LEVEL RCC STRUCTURAL PLAN

GL/PLINTH LEVEL RCC STRUCTURAL PLAN

NAME OF WORK :- PROPOSED CONSTRUCTION OF SHED FOR CATTLE FEED UNITS, STORAGE OF RAW MATERIALS & CATTLE FEED FOR ATULNIYA FARMERS PRODUCER COMPANY LTD. WAREHOUSING TO PHULAMBRI DIST. STRUCTURAL DESIGN BY

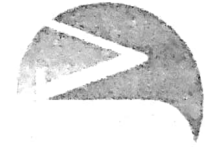

JV Structural Engineers & Consultants
 OFFICE :- Plot 311/P, Opp Patel Junior College, Hussain Nagar, Beed By Pass Aurangabad.
 Mobile :- 9423028563, 9673071706
 Email :- jvstructural@rediffmail.com

BEAMS AT PLINTH LEVEL PLAN
 B1 - 230 X 600

EMPANELMENT ON P.W.D REGION AURANGABAD AS A STRUCTURAL DESIGNERS VIDE C.F. IIR NO. C.A.D-74625 OF D.T. 21-08-2019

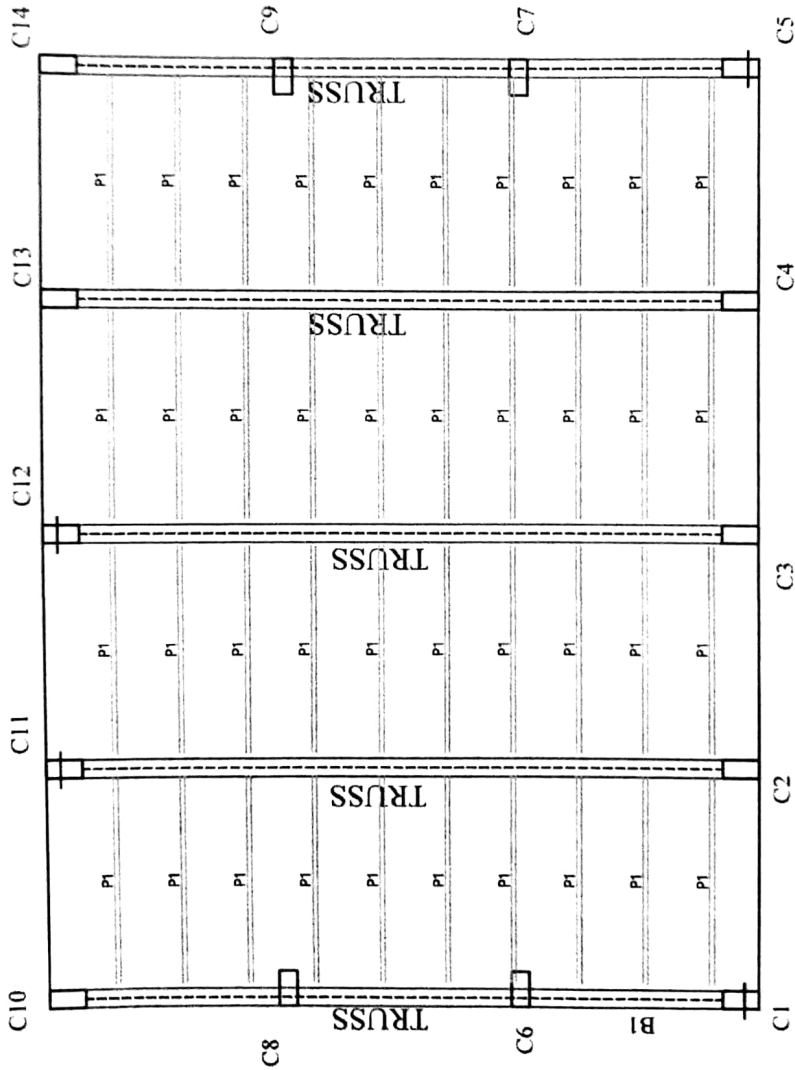

DETAILS OF TRUSS BOTTOM LEVEL RCC STRUCTURAL PLAN

DETAILS OF TRUSS BOTTOM LEVEL RCC STRUCTURAL PLAN
 NAME OF WORK - PROPOSED CONSTRUCTION OF SHED FOR CATTLE FEED UNITS, STORAGE OF RAW MATERIALS & CATTLE FEED FOR ATUL NIYA FARMERS PRODUCER COMPANY LTD. WAREGAON TQ. PHULAMBRI DIST.

STRUCTURAL DESIGN BY



JV Structural Engineers & Consultants

OFFICE :- Plot 311/P.Opp Patel Junior College,
 Husaam Nagar, Beed By Pass Aurangabad
 Mobile 9423028563, 9673071706
 Email jvstructural@rediffmail.com

EMPANELMENT ON PWD REGION AURANGABAD AS A STRUCTURAL DESIGNERS VIDE C.E. LTR NO. C.A.D-7/625 OF DT-21-08-2019

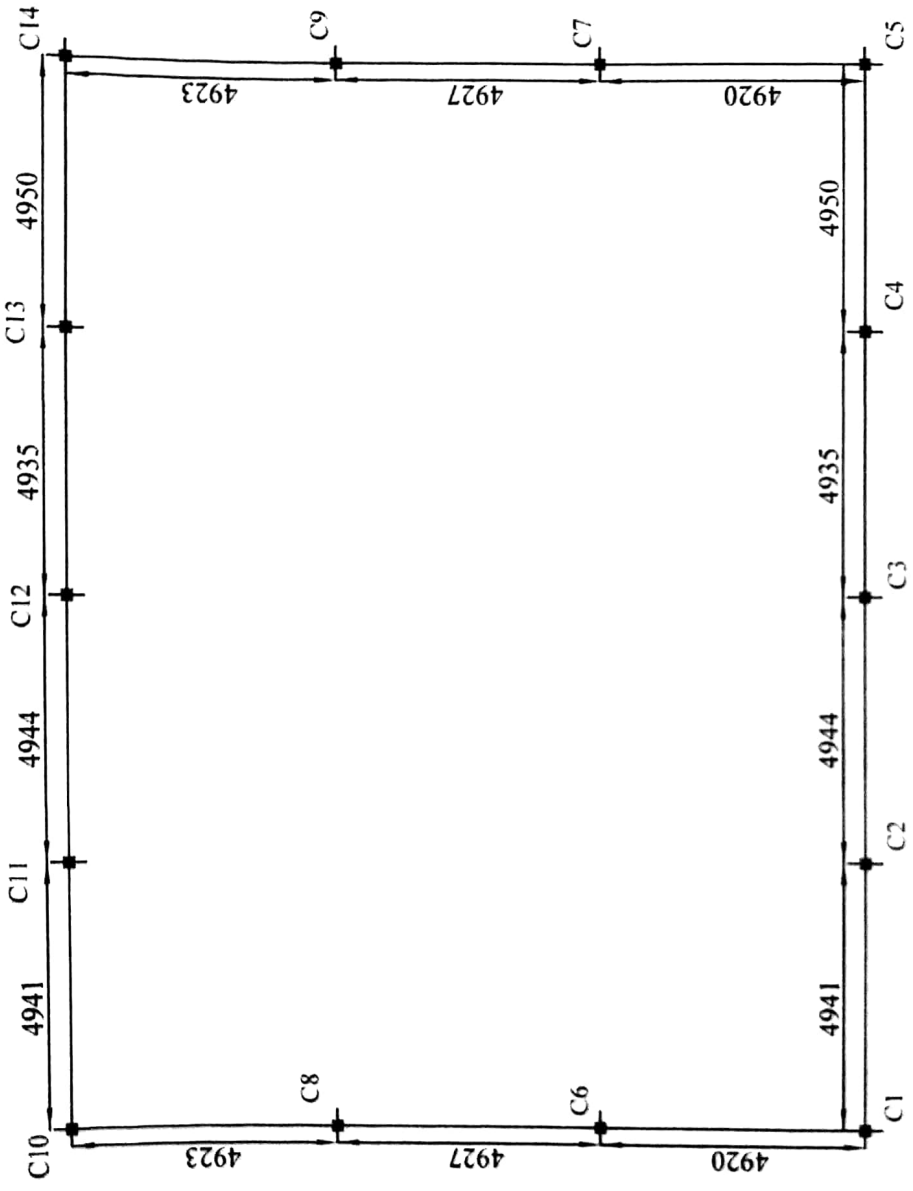

BEAM CENTRE LINE Plan



Ref No : IEEPL/Offer HO/22-23/242

Date : 04th February 2023

To,
Atulniya Farmers Producer Company Ltd
Waregaon, Tq. Phulambri
Dist . Aurangabad

Subject : Estimate for supply & installation of lighting system for Cattel Feed shed

Dear Sir,

With reference to above subject and your enquiry, we are pleased to submit our offer as per price schedule and other details enclosed, subject to following terms and conditions. Please explore through the same and revert for any kind of assistance you might need in context of this subject;

Commercial Terms and Conditions:

1.	Price Basis	As per enclosed PRICE SCHEDULE
2.	Address	<ul style="list-style-type: none">• P.O. to be placed on office address :-• IDEAS ELECTRICALS & ENGINEERS PVT LTD, Plot. no. 32, Gut no. 44, Near Bajaj Hospital, Uma Gopal Nagar, Beed by pass, Aurangabad, PIN-431005• GST- 27AAFCI1160D1Z0
3.	Taxes & Duties	<ul style="list-style-type: none">• Shall be extra as applicable at the rates prevailing at the time of dispatch.• Present rate is GST@18%.
4.	Terms of Payment	30% advance along with order & balance 70% plus taxes against proforma invoice
5.	Delivery period	Within 03-04 weeks from the date of purchase order and receipt of advance payment.
6.	Validity	15 days from the date of offer.
7.	Billing & Dispatch	From IDEAS ELECTRICALS & ENGINEERS PVT. LTD. Aurangabad

Corp. Office : "IDEAS HOUSE" Plot No. 32, Gut No. 44, Near Bajaj Hospital,
Uma Gopal Nagar, Beed by pass, Aurangabad - 431010 M.H. India
Phone : (01) 210735 0300, +91 946-2452829, 2453136
Visit us at : <http://www.ideasengineers.com>, E mail : info@ideasengineers.com



Setting Global Standard...

IDEAS ELECTRICALS & ENGINEERS PRIVATE LIMITED
CIN : U74999MH2014PTC118796
Formerly known as IDEAS ENGINEERS



Force Majure:

- If any time during the continuance of this contract, the performance, in whole or in part, of any obligation under this contract shall be prevented or delayed at our / our sub suppliers works by reasons by any war (whether declared or otherwise), hostility, acts of the public enemy, civil commotion, sabotage, fires, floods, explosive, earthquake, epidemics, quarantine restrictions, strikes, labour dispute, lockouts, compliance with regulations, orders or instructions of any central, state or municipal government or agencies thereof, inability to obtain material or sufficient electricity for full manufacturing operations, any act of God, then provided notice of the happening of any such eventuality is given by us to the purchaser within a reasonable period of time from the date of eventuality, the suitable extension of delivery time shall be granted by the purchaser.

We believe, this is in-line with your requirement, we look forward your positive response soon on this subject.

Thanking you
Yours Sincerely

IDEAS ELECTRICALS & ENGINEERS PVT.LTD.

Authorized Signatory



Corp. Office : "IDEAS HOUSE" Plot No. 32, Gut No. 44, Near Bajaj Hospital,
Jyoti Chawl, Naxal, Beed by hours, Aurangabad - 431010, M.H. India
Phone : +91 80637 03636, +91 240-2452088, 2453636
Visit us at : www.ideasengineers.com E-mail : info@ideasengineers.com



Setting Global Standard...

**IDEAS ELECTRICALS &
ENGINEERS PRIVATE LIMITED**
CIN: U74999MH2018PTC316796
Formerly known as IDEAS ENGINEERS



PRICE SCHEDULE

Sr	Particulars	UOM	Qty	Unit Rate	Amount
1	Supply & Installation of Incomer Panel	No	1	25,500.00	25,500.00
2	Supply & Installation of Double door IP43 type SPN/TPN/VTPN Lighting D.B. with necessary MCB AND RCCB	No	1	10,500.00	10,500.00
3	Supply & Installation of LED Light fittings 25 Watt with mounting arrangement	No	20	2,550.00	51,000.00
4	Supplying and Laying of Armoured LT Cables - XLPE - FR - 1100V - Cabling in saddled to wall, through pipe and wiring suitable Aluminium tags 4 C X 25 sq mm Al. armoured XLPE	Mtr	50	215.00	10,750.00
5	Supplying and laying of copper Flexible cable LT Cables - FR - 1100V - Cabling in saddled to wall through pipe and wiring suitable Aluminium tags 4C x 2.5 Sq.mm copper Flexible cable	Mtr	100	130.00	13,000.00
6	Supply & Installation of Termination material	Lot	1	9,500.00	9,500.00
7	Supply & Installation of 250W LED Floodlight Luminaire, suitable for Wall / Column Mounting	No	4	8,500.00	34,000.00
Total Amount					154,250.00



Setting Global Standard...

Corp. Office : "IDEAS HOUSE" Plot No. 32, Gut No. 44, Near Bajaj Hospital,
Uma Gopal Nagar, Road overpass, Aurangabad - 431010 M.H. India
Phone : +91 20178 03636, +91 240 2452828, 2453026
Visit us at : <http://www.ideasengineers.com>, E mail : info@ideasengineers.com



**IDEAS ELECTRICALS &
ENGINEERS PRIVATE LIMITED**

CIN: U74999MH2018PTC318796
Formerly known as IDEAS ENGINEERS